

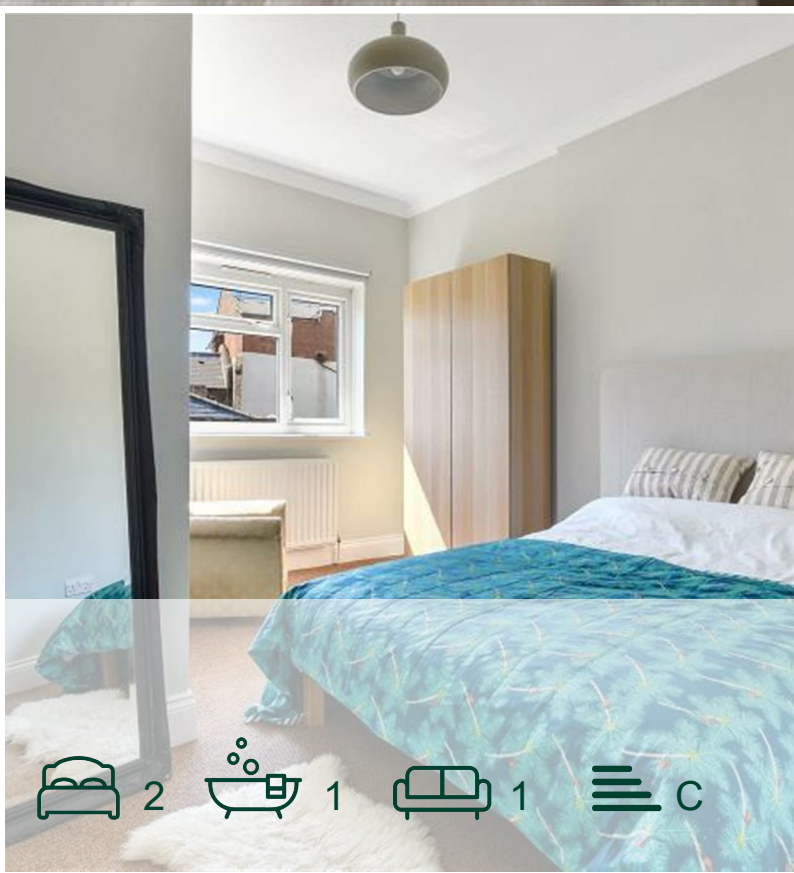

St Julians Road, Kilburn,
London

£1,990 Per Month



 2
  1
  1
  C

St Julians Road, Kilburn, London

£1,990 Per Month



Summary Description

A charming and modern two bedroom raised ground floor flat located on quiet residential road with a short walk from Queens Park and Kilburn Park tube stations (Bakerloo Line - Zone 2), Kilburn tube station (Jubilee Line - Zone 2) and Kilburn High Road Overground. The apartment benefits from large living room with high ceilings, original features, two good sized double bedrooms, fully fitted kitchen open plan, family bathroom, double glazing, gas central heating and good level of storage.

Available from 19th of April. Please call Jorgensen Turner Estate Agents to arrange a viewing. One week's holding deposit will be required, 5 weeks damage deposit will be required, EPC rating C, council tax band C.

Area Map

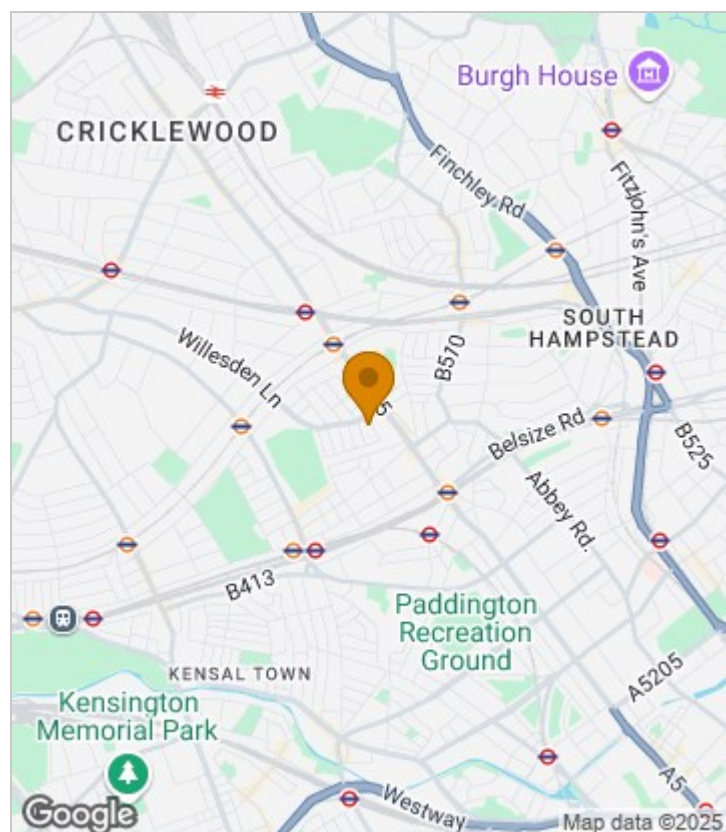



Floor Plan

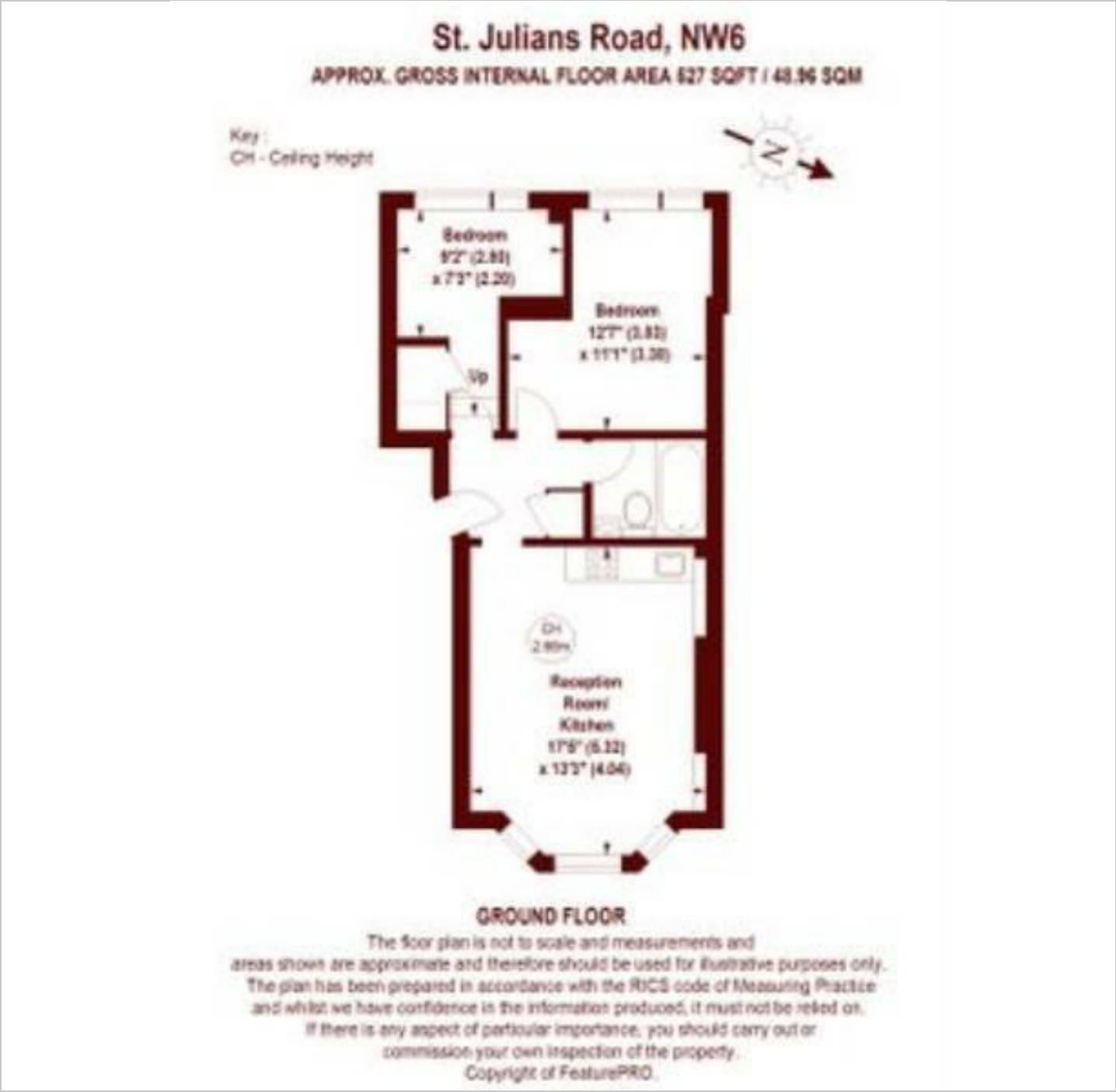

Energy Efficiency Graph

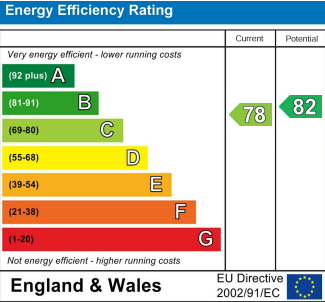

Viewing

Please contact our Lettings QP Office on 0207 604 4040 if you wish to arrange a viewing appointment for this property or require further information.

For further information contact:
Lettings QP, 2a Brondesbury Road, London, NW6 6AS
Tel: 0207 604 4040 Email: info@jorgensenturner.com <https://www.jorgensenturner.com/>



Disclaimer
These particulars, whilst believed to be accurate are set out as a general outline only for guidance and do not constitute any part of an offer or contract. Intending purchasers should not rely on them as statements of representation of fact, but must satisfy themselves by inspection or otherwise as to their accuracy. No person in this firms employment has the authority to make or give any representation or warranty in respect of the property.